

Tools required :  
- 4mm hex key (included)

# LUNA TABLE

## ASSEMBLY INSTRUCTIONS

**!! Important**  
Do not use power tools on this assembly.  
Use the supplied manual hex key.



- 1 Use the carton as a protective work surface.
- 2 Line up the legs with the corresponding hole in the table top, then secure it using the supplied M6x25mm bolts.

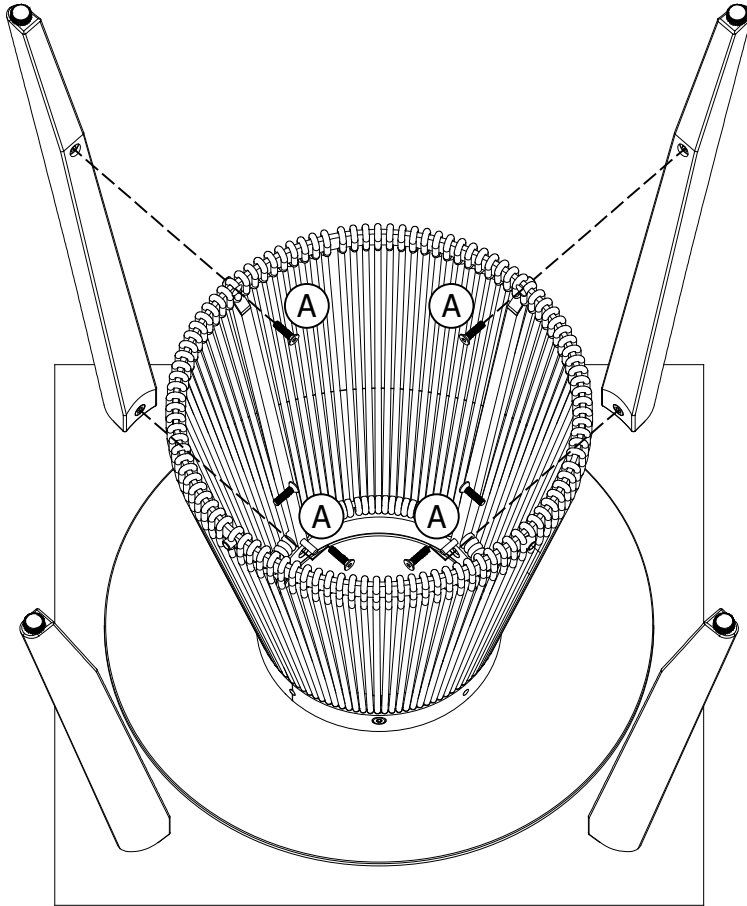

**A** BOLT M6x25mm

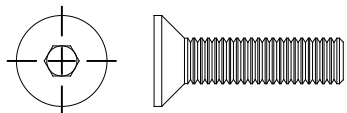

8 pcs

- 3 Turn the table right-side-up. Place the LED module into the top of the table by loosening the set screw. Once fitted, fasten the set screws using the supplied hex key.

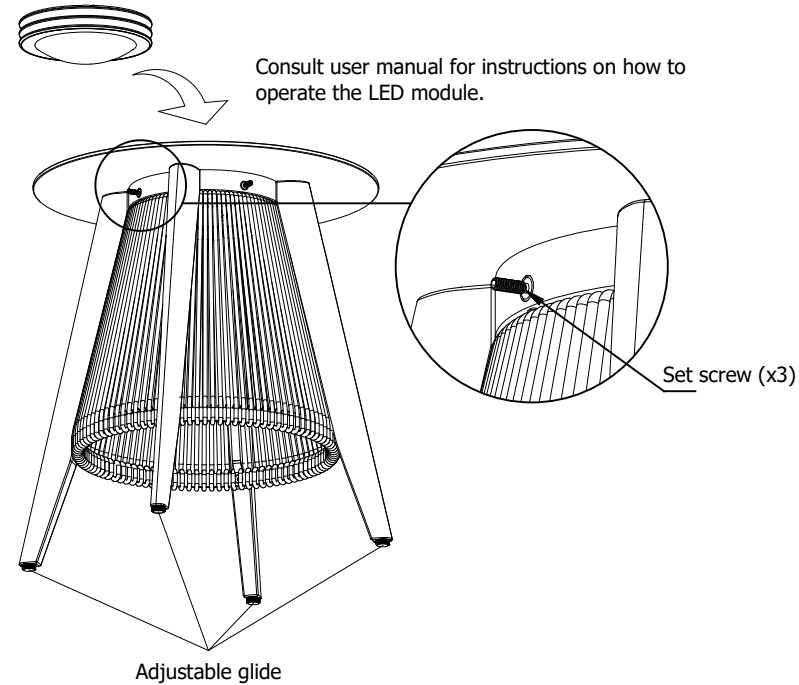

Adjustable glide

Level the table using the adjustable glide.

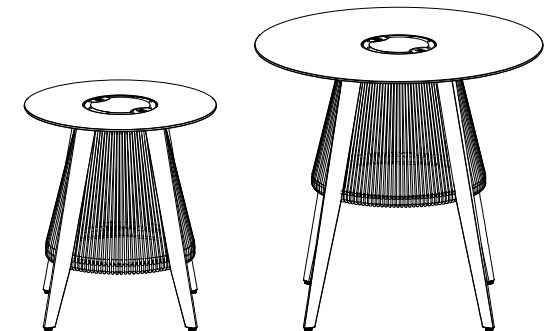

Side Table

Small Table